

# Leca<sup>®</sup> - Solid Floor Insulation Fill

Using Traditional Materials

Using Leca<sup>®</sup>

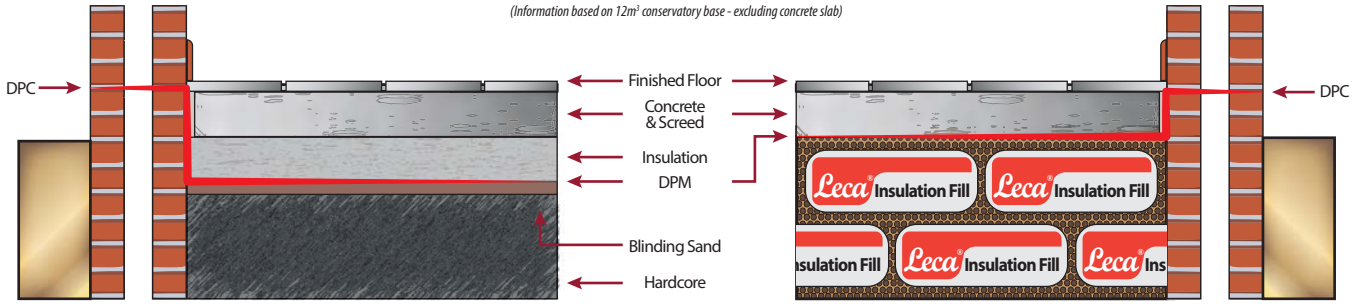

### Materials, Labour & Time Required

### Materials, Labour & Time Required

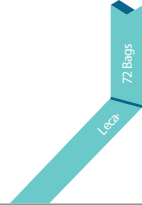
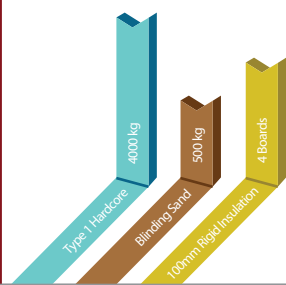

## Save Time

Leca<sup>®</sup> Insulation Fill provides a proven method of providing underfloor thermal insulation replacing both insulation board and hardcore in new-build and refurbishment construction.

Leca<sup>®</sup> Insulation Fill is a coated granular expanded clay lightweight aggregate of dry bulk density 280 kg/m<sup>3</sup>.

**The installation of under-floor insulation is required in order to comply with regulation L2 of the Building Regulations 2000.**

U-value (W/m <sup>2</sup> k)	Nominal Depth (mm)	Quantity (Bags per m <sup>2</sup> )
0.22	300	6
0.12	450	9
0.09	600	12

Figures based on 50mm self levelling floor compound or 100mm standard concrete covering slab

## Save Costs

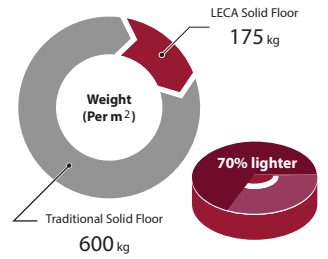

With no need for heavy lifting equipment to install Leca<sup>®</sup>, save on equipment hire costs and machine maintenance bills.

Buy Online at...

[www.SpecialistAggregates.com](http://www.SpecialistAggregates.com)

### Leca<sup>®</sup> 10-20mm

Lightweight Expanded Insulation Fill

Product Code

**7897**

Particle Size (mm)



Approx' Density (Kg / m<sup>3</sup>)



Available in 1m<sup>3</sup> pallet packs (21 x 50 Ltr bags)



21 bags = Approx' 7m<sup>2</sup> coverage at 150mm thick

